

# *ASSEMBLING INSTRUCTIONS -KMI- INSIDE THE POWER UNIT WITH TANDEM JACKS*

## *PUMP FLOW UP TO 250 l/min.*

- 1) *ASSEMBLE THE STEEL PIPE (PRE-ASSEMBLED WITH NUT AND RING) AT THE BALL VALVE EXIT.*
  
- 2) *ASSEMBLE THE PRE-ASSEMBLED FITTING 0831/... ON THE PILOTED STOPPING VALVE, USING THE 4 SCREWS AND THE "OR" GASKET.*
  
- 3) *SCREW THE PILOTED STOPPING VALVE ON THE STEEL PIPE SECTION.*
  
- 4) *CONNET THE FLEX HOSE ON FITTING Cod. 0831/... (SUPPLIED PRE-ASSEMBLED).*
  
- 5) *KMI DEVICE IS SUPPLIED PRE-ASSEMBLED IN THE POWER UNIT.*
  
- 6) *TO BE DONE BY CUSTOMER:  
CONNECT THE MINIFLEX M14x1.5 HOSE (90° SIDE) TO THE ADAPTOR NIPPLE (PILOTED STOPPING VALVE).  
CONNECT THE MINIFLEX STRAIGHT SIDE TO THE NON RETURNING VALVE, WHICH IS LOCATED ON THE "OUT" PORT OF THE KMI DEVICE.*

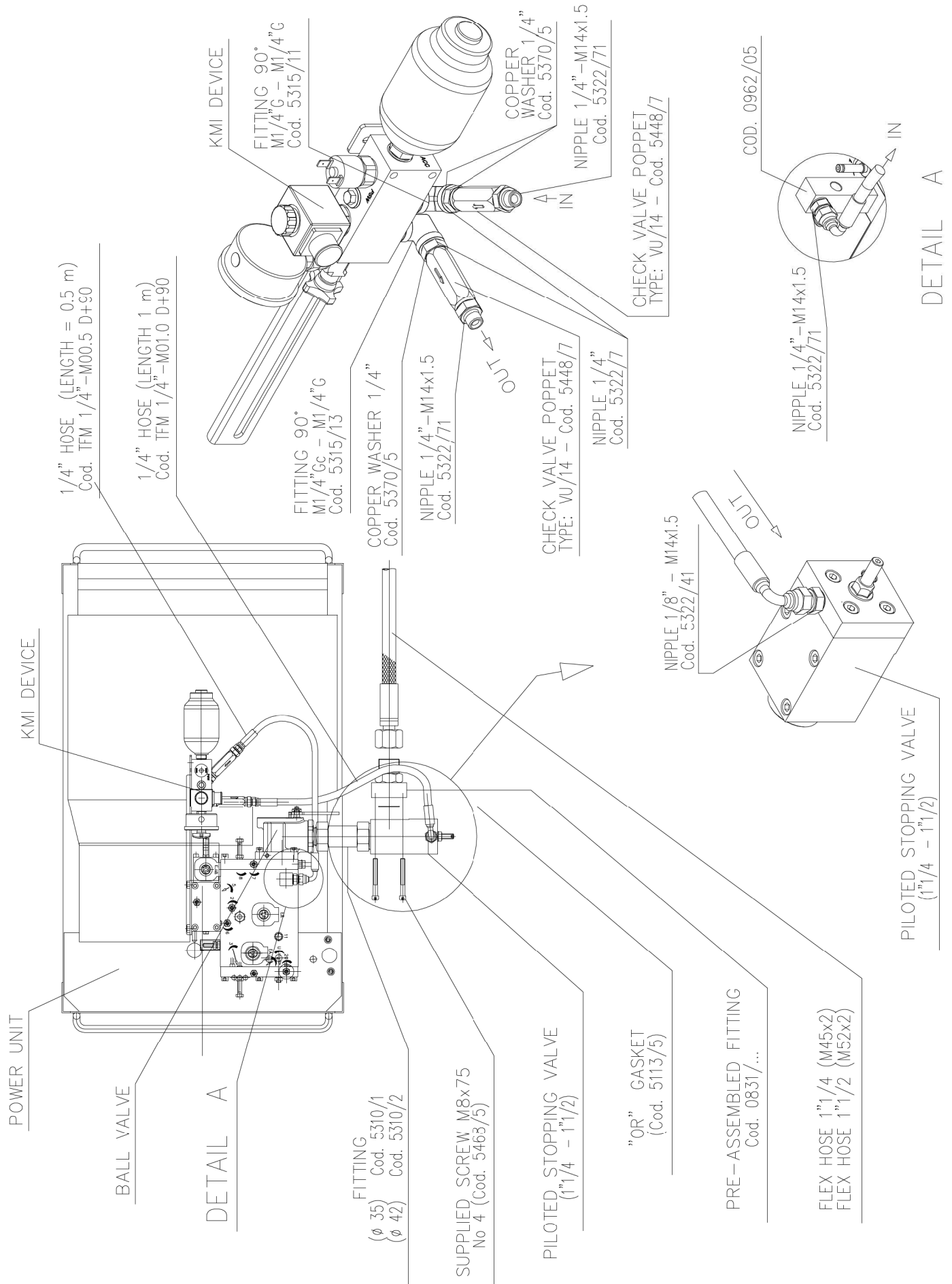

# *ASSEMBLING INSTRUCTIONS -KMI- INSIDE THE POWER UNIT WITH TANDEM JACKS*

## ***PUMP FLOW FROM 300 l/min. TO 380 l/min.***

- 1) *ASSEMBLE THE BALL VALVE ON THE TANK EXTERNAL FLANGE.*
- 2) *ASSEMBLE THE STEEL PIPE (PRE-ASSEMBLED WITH NUT AND RING) AT THE BALL VALVE EXIT.*
- 3) *ASSEMBLE THE PRE-ASSEMBLED FITTING Cod. 0831/... ON THE PILOTED STOPPING VALVE, USING THE 4 SCREWS AND THE "OR" GASKET.*
- 4) *SCREW THE PILOTED STOPPING VALVE ON THE STEEL PIPE SECTION.*
- 5) *CONNET THE FLEX HOSE ON FITTING 0831/... (SUPPLIED PRE-ASSEMBLED).*
- 6) *KMI DEVICE IS SUPPLIED PRE-ASSEMBLED IN THE POWER UNIT.*
- 7) *TO BE DONE BY CUSTOMER:  
CONNECT THE MINIFLEX M14x1.5 HOSE (90° SIDE) TO THE ADAPTOR NIPPLE (PILOTED STOPPING VALVE).  
CONNECT THE MINIFLEX STRAIGHT SIDE TO THE NON RETURNING VALVE, WHICH IS LOCATED ON THE "OUT" PORT OF THE KMI DEVICE.*

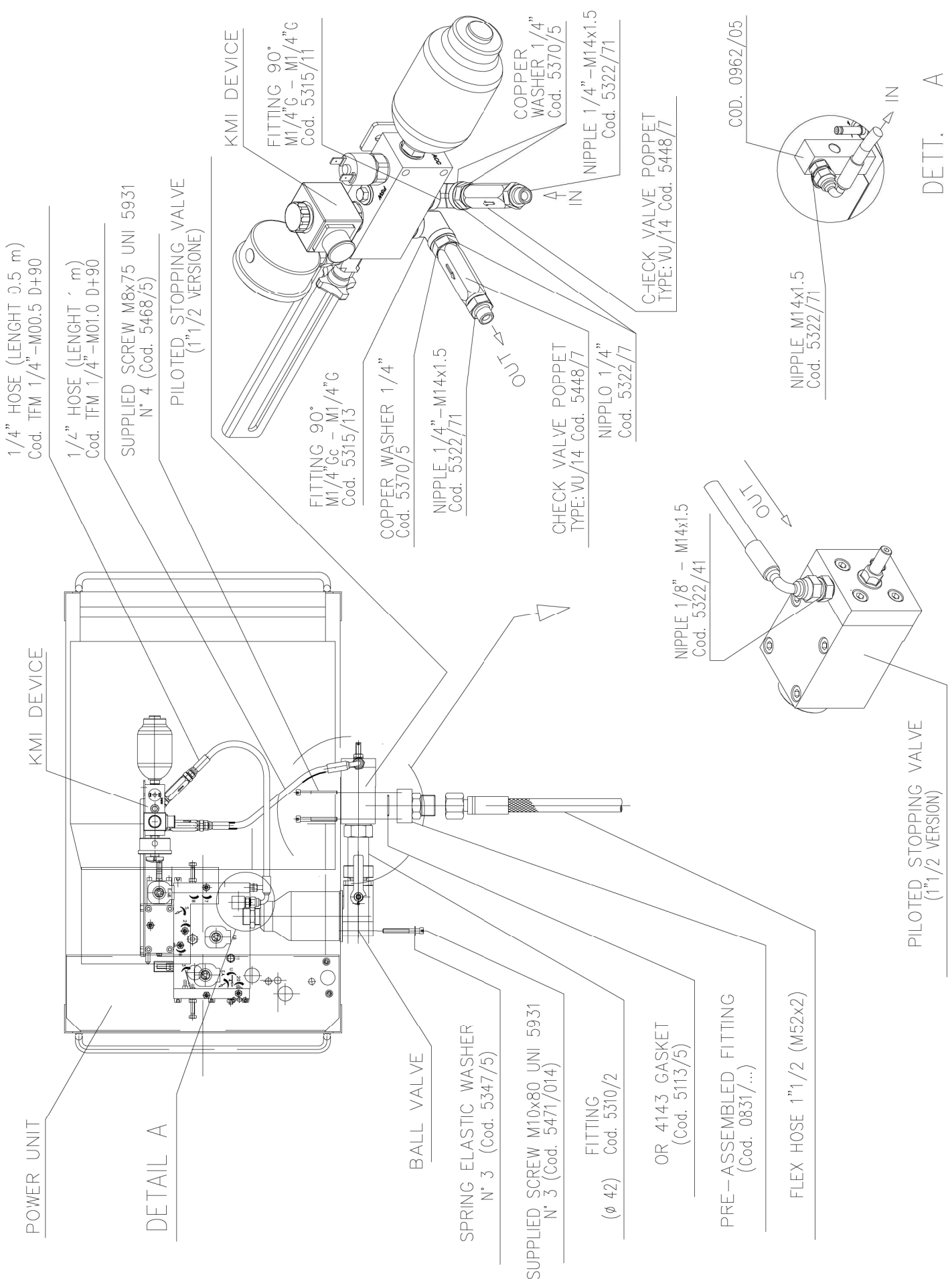

DETT. A

# *ASSEMBLING INSTRUCTIONS -KMI- INSIDE THE POWER UNIT WITH TANDEM JACKS*

***TOTAL FLOW FROM 440 l/min. TO 650 l/min.***

- 1) *SCREW THE CONICAL 2" NIPPLE ON THE BALL VALVE WITH TEFLON.*
- 2) *SCREW THE PILOTED STOPPING VALVE (2" VERSION) ON THE OTHER END OF THE CONICAL 2" NIPPLE, WITH TEFLON. PLEASE PAY ATTENTION: DIRECT THE PILOTED STOPPING VALVE OUTPUT ON THE CORRET SIDE.*
- 3) *ASSEMBLE THE FITTING Cod. 0979/M2-F2 ON THE PILOTED STOPPING VALVE.*
- 4) *CONNECT THE FLEX HOSE ON THE SUPPLIED FITTING Cod. 0979/M2-F2.*
- 5) *KMI DEVICE IS SUPPLIED PRE-ASSEMBLED IN THE POWER UNIT.*
- 6) *TO BE DONE BY CUSTOMER:  
CONNECT THE MINIFLEX M14x1.5 HOSE (90° SIDE) TO THE ADAPTOR NIPPLE (PILOTED STOPPING VALVE).  
CONNECT THE MINIFLEX STRAIGHT SIDE TO THE NON RETURNING VALVE, WHICH IS LOCATED ON THE "OUT" PORT OF THE KMI DEVICE.*

